

# SOUTH ROAD SUPERWAY TRAFFIC CHANGES

## Grand Junction Road / South Road intersection closure

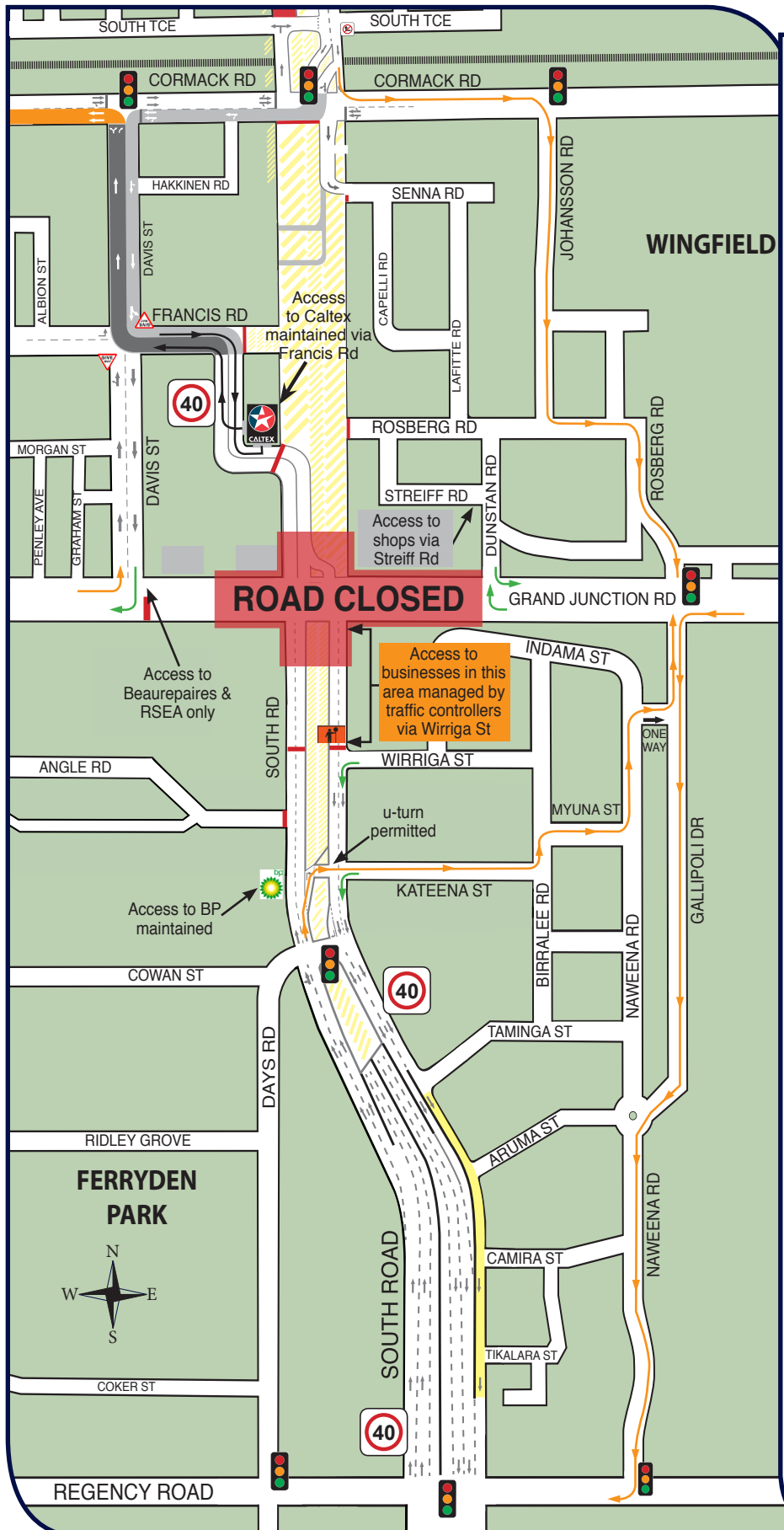

Work to construct the South Road Superway in Regency Park is progressing well and the project has now reached the stage where the intersection of Grand Junction Road and South Road will be reconstructed.

This is a key milestone for the project and will significantly improve traffic flow on Grand Junction Road past South Road when complete.

This intersection is a major thoroughfare for traffic and the new road pavement cannot be placed while traffic is using the roadway, therefore **the intersection will be closed for three consecutive weekends.**

Detours will be in place around the intersection of Grand Junction Road and South Road, Regency Park from:

- 7.30pm on **Friday 2 August** until 6.30am **Monday 5 August\***;
- 7.30pm on **Friday 9 August** until 6.30am **Monday 12 August\***; and
- 7.30pm on **Friday 16 August** until 6.30am **Monday 19 August\***.

Detours will be in place and motorists are advised to seek alternative routes during these times including Gallipoli Drive, Hanson Road, Cormack Road and Regency Road (shown overleaf).

Access to South Road will be maintained from Days Road, Wurriga Street and Kateena Street. It will also be possible to u-turn on South Road at the Kateena Street intersection.

For more information about this closure or any other aspect of the project please call the project information line on **1300 638 789** or email [contactus@urbansuperway.com.au](mailto:contactus@urbansuperway.com.au)

*\*This activity cannot be completed in wet weather, therefore these dates may change. Notice will be provided of any changes.*

Construction area

\* This map is indicative only and not to scale



Urban Superway, comprising John Holland Pty Ltd and Leed Engineering and Construction Pty Ltd, is the design and construction contractor delivering the \$842 million Australian and South Australian government funded South Road Superway with the Department of Planning, Transport and Infrastructure.

# SOUTH ROAD SUPERWAY TRAFFIC CHANGES

## Grand Junction Road / South Road intersection closure



Construction Area



\* This map is indicative only and not to scale



Urban Superway, comprising John Holland Pty Ltd and Leed Engineering and Construction Pty Ltd, is the design and construction contractor delivering the \$842 million Australian and South Australian government funded South Road Superway with the Department of Planning, Transport and Infrastructure.